

Vom Einfamilienhaus zum Hochhaus

Die Renaissance des Holzbaues

Ciril Stadler

Timbatec Holzbauingenieure Schweiz AG

Timbatec
Timber and Technology

Leitfaden

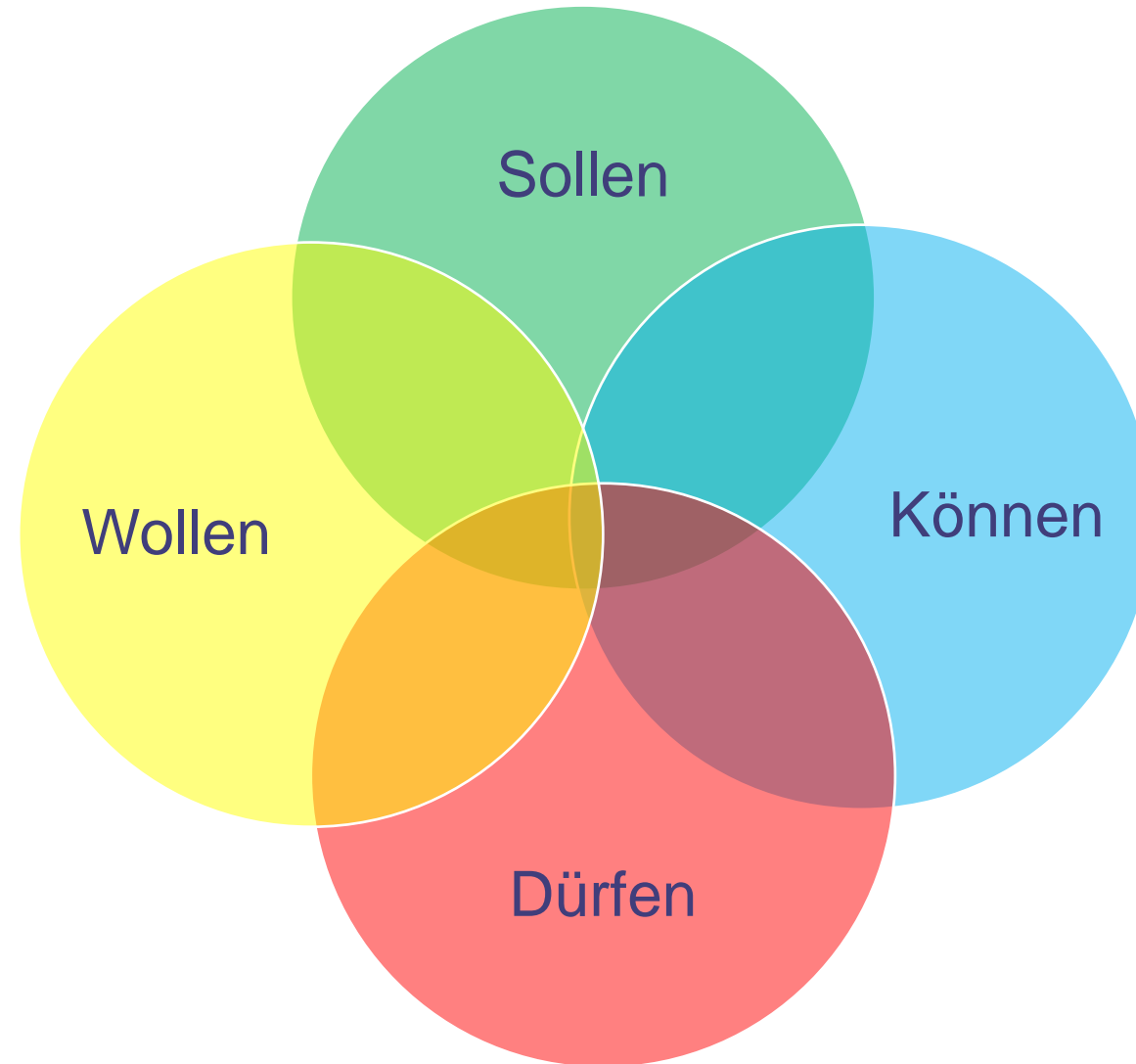

Sollen

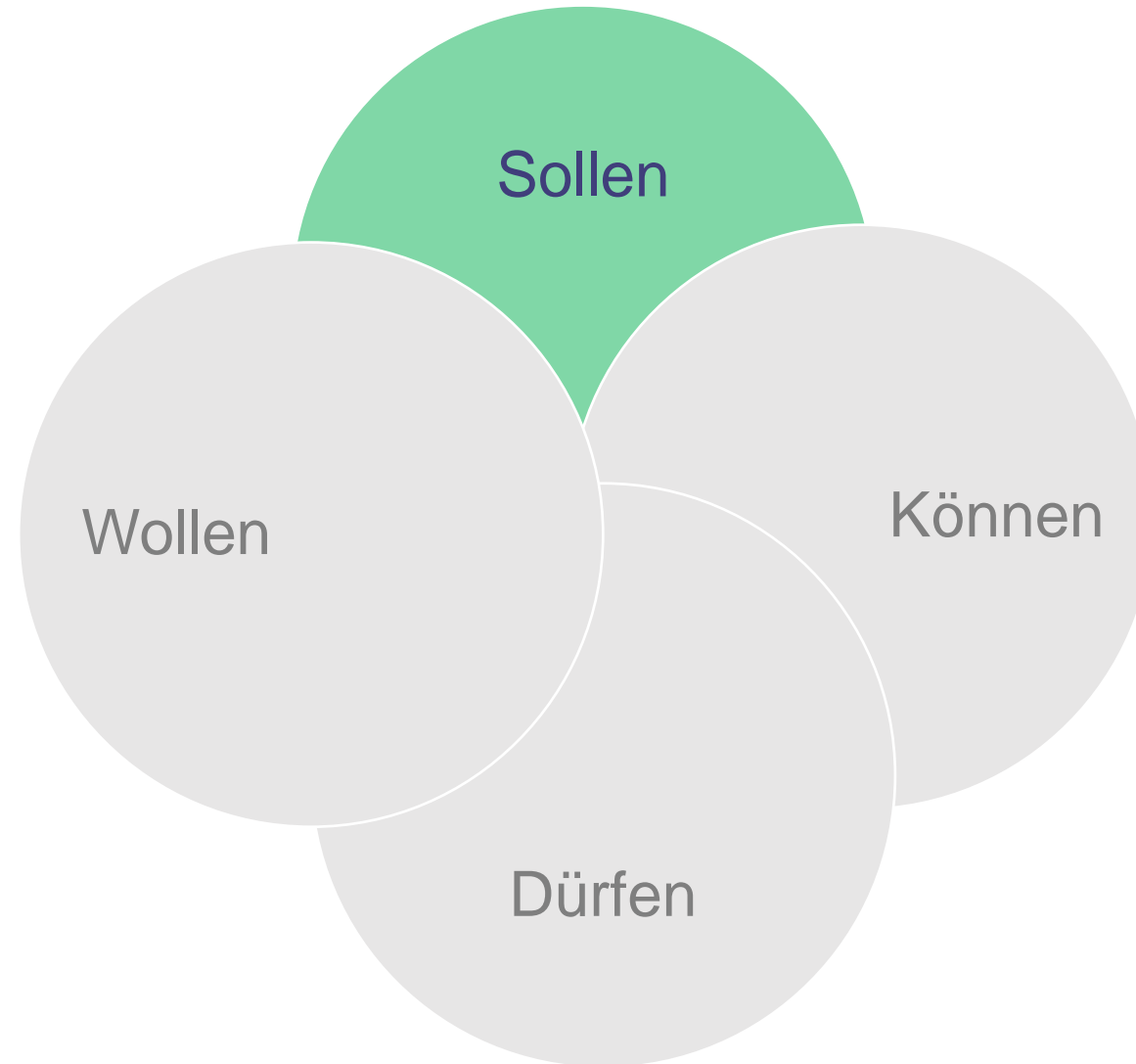

A large tree stands on a grassy hill under a blue sky with clouds. The tree is split vertically: the left side is lush with green leaves, while the right side is a skeletal, leafless structure. The word "Sollen" is written in white across the center of the tree.

Sollen

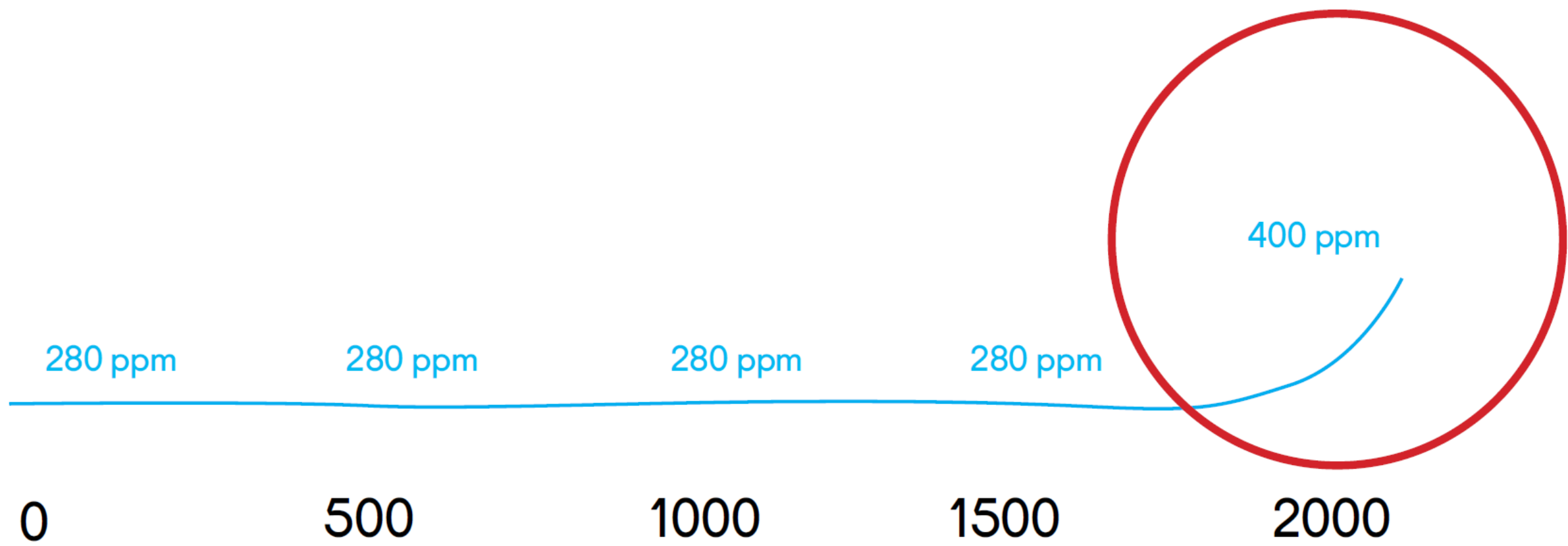

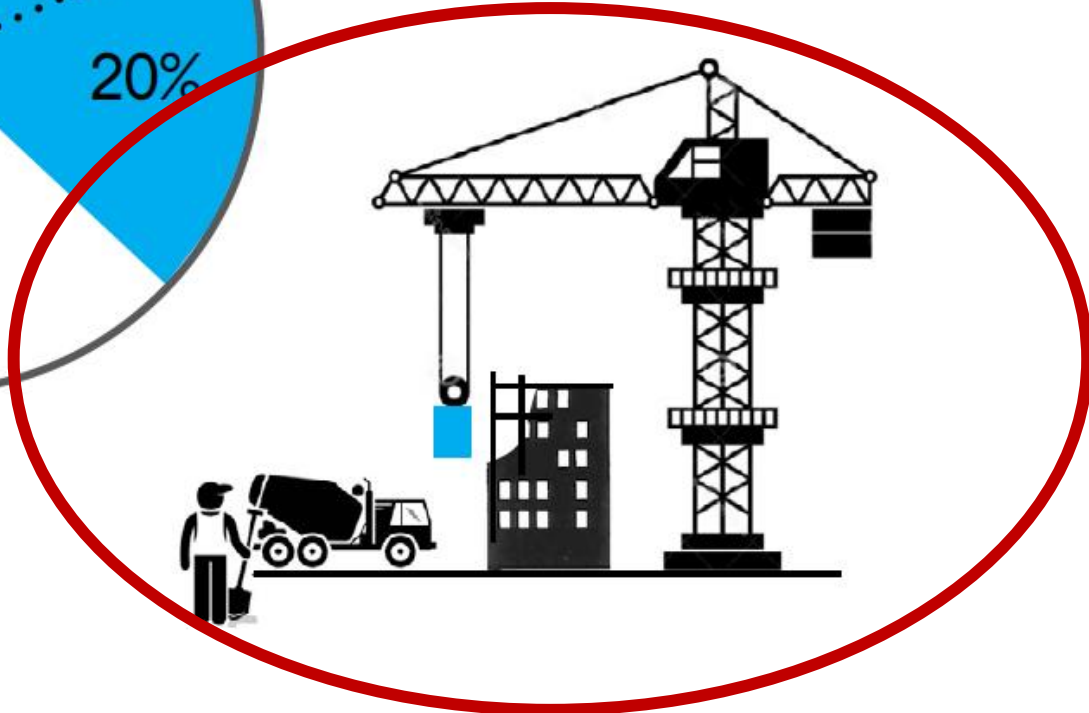
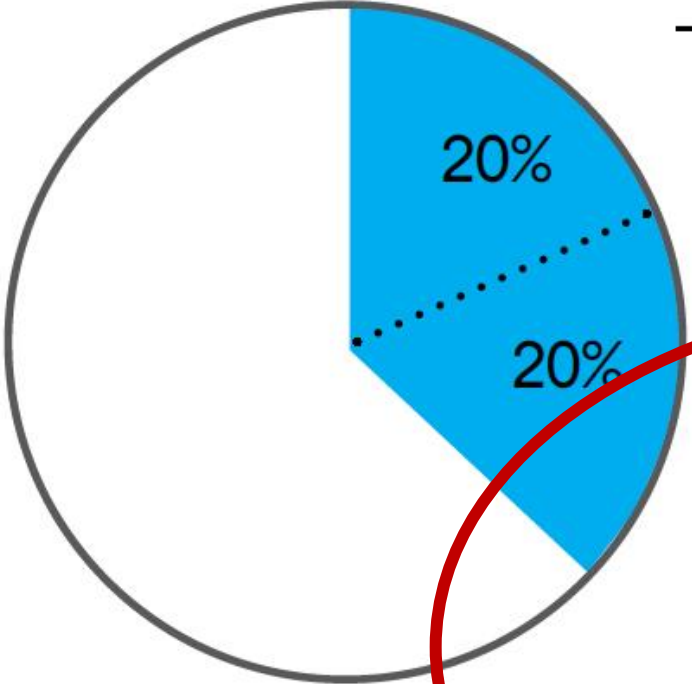
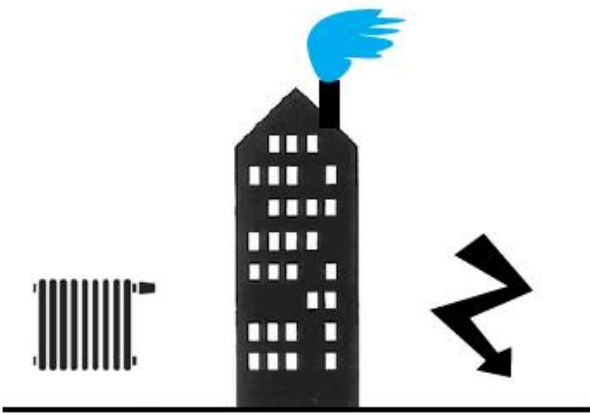

Source: IPCC

CO₂-Ausstoss pro Jahr

In der Schweiz: 47.2 Megatonnen pro Jahr

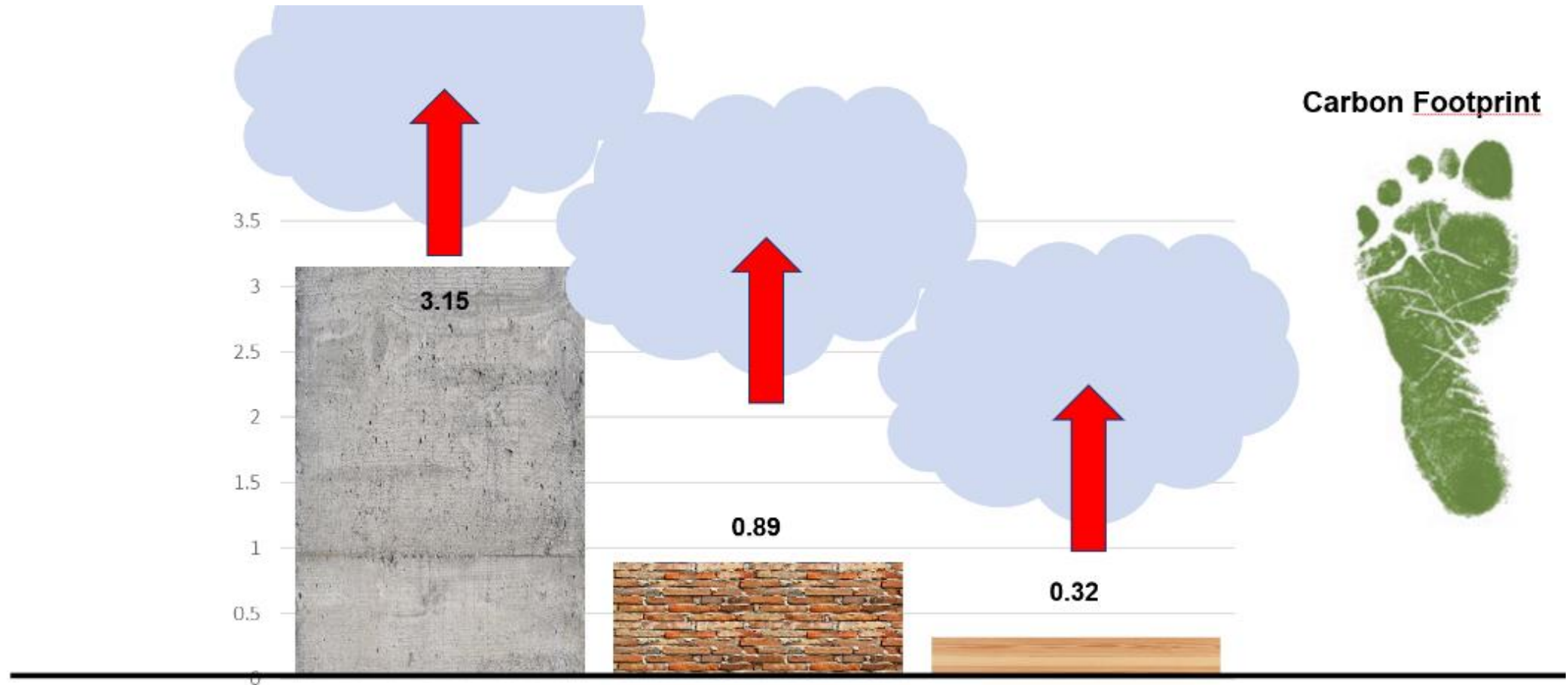

Holz - CO₂-Speicher

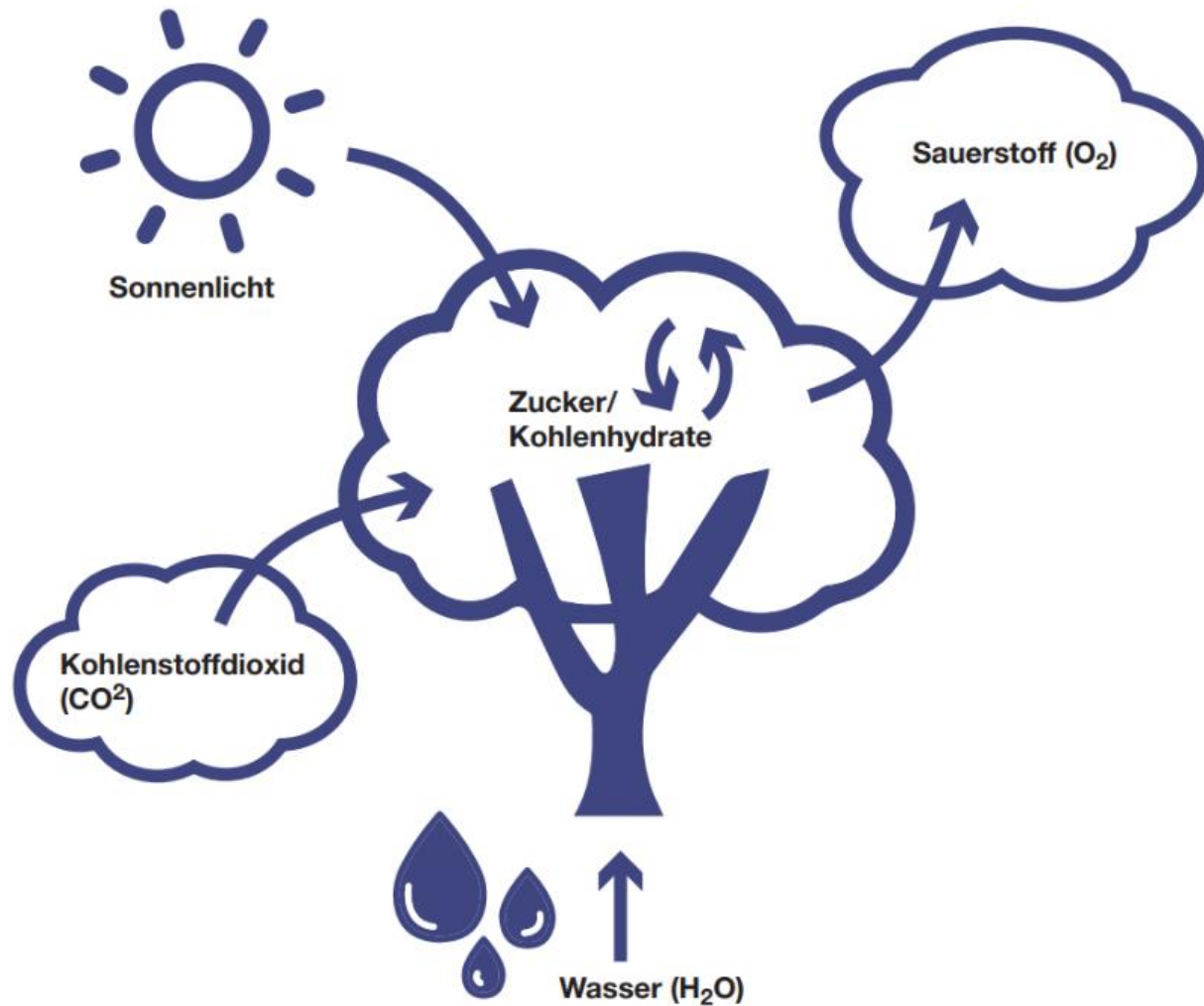

CO₂-Ausstoss pro Jahr

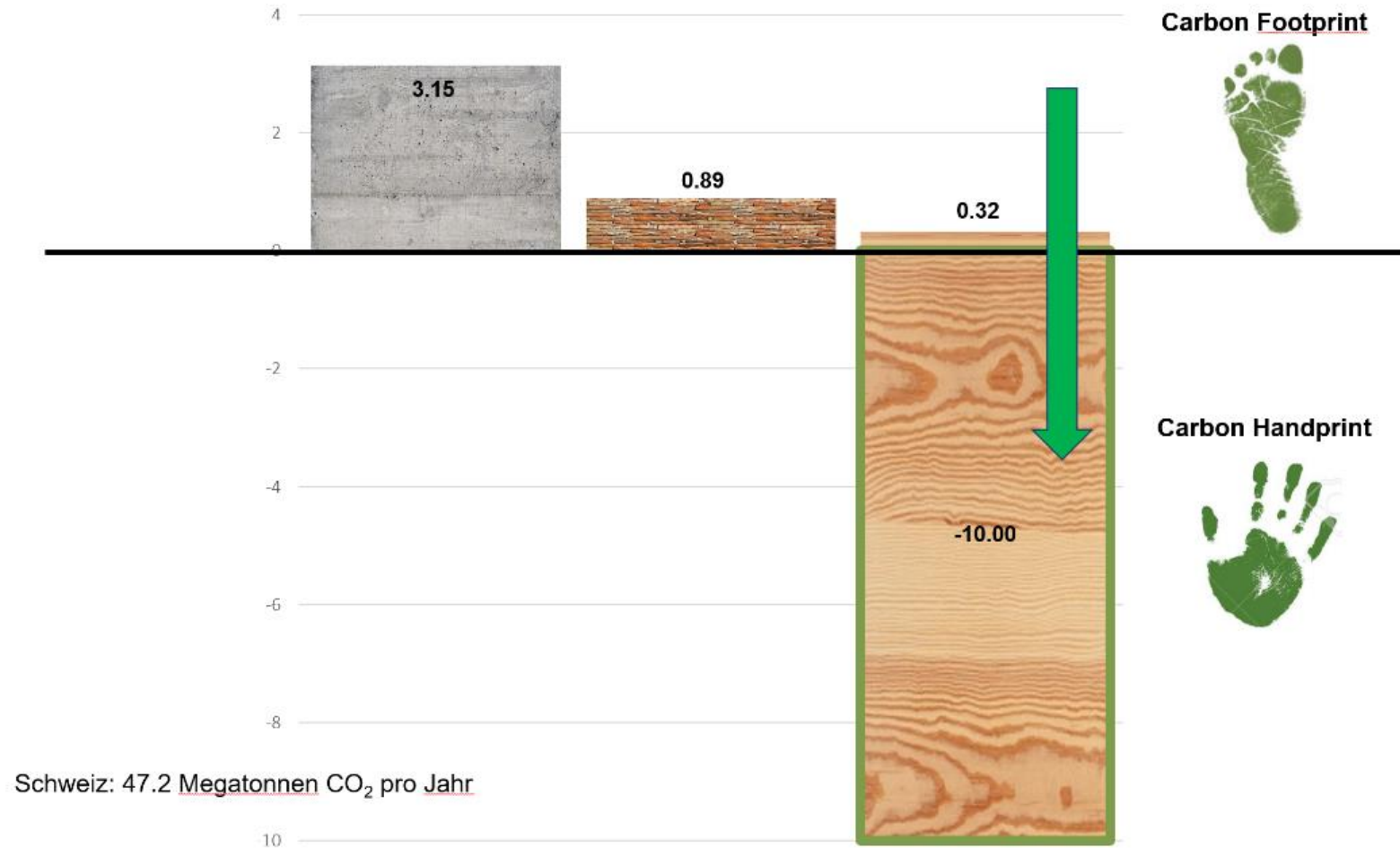

Holz – Re-use

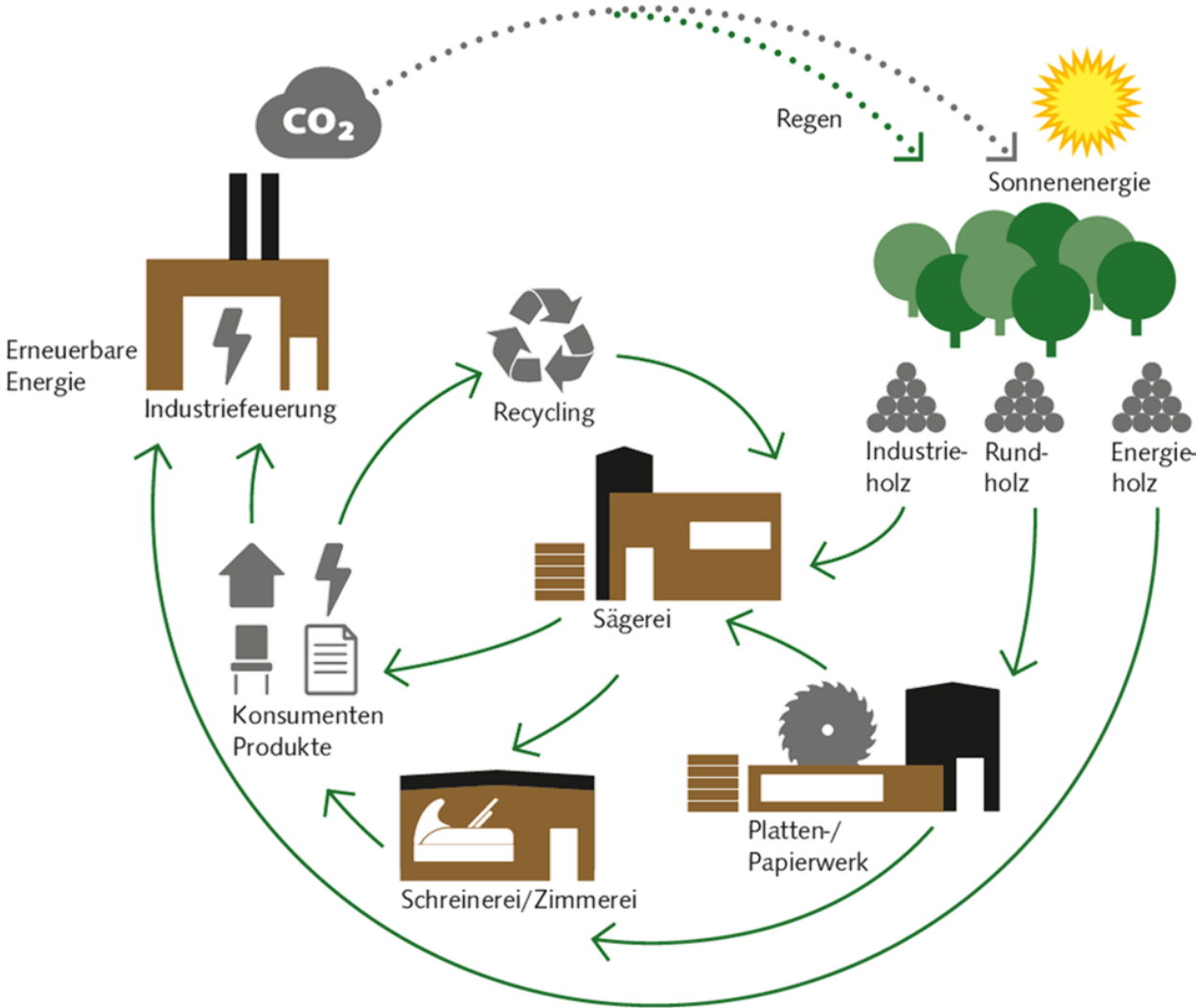

Holz – Ein Leichtgewicht

Holzbau ca. 60% leichter als Massivbau

Verhältnis Eigengewicht zu Nutzlast 4 (bei Massivbau ca. 10)



Dürfen

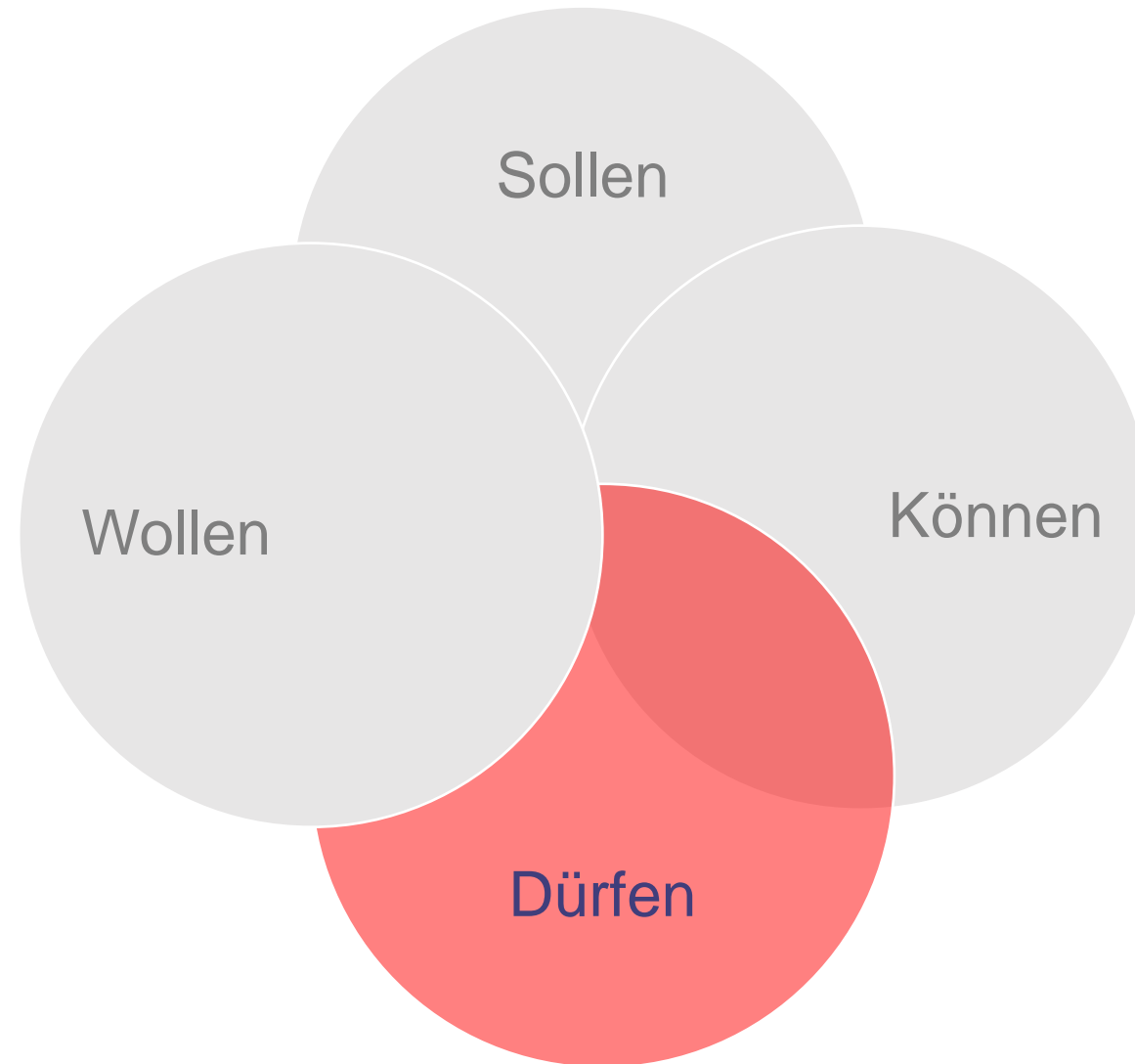



Dürfen



Brandschutz

1983

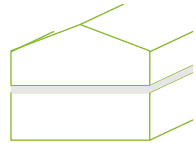

Wohnen

Holzbautechnische
Alternative F0/IV
oder F30/IV*

1993

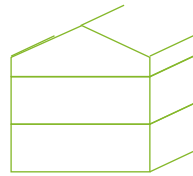

Wohnen/Büro/Schule

F30bb

2003

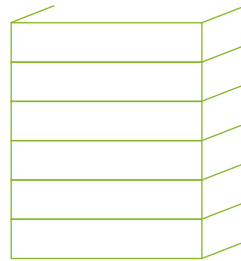

Wohnen/Büro/Schule/Industrie

R / EI / REI
REI 30
REI 60
REI 60/EI 30 (nbb)

2015-2025

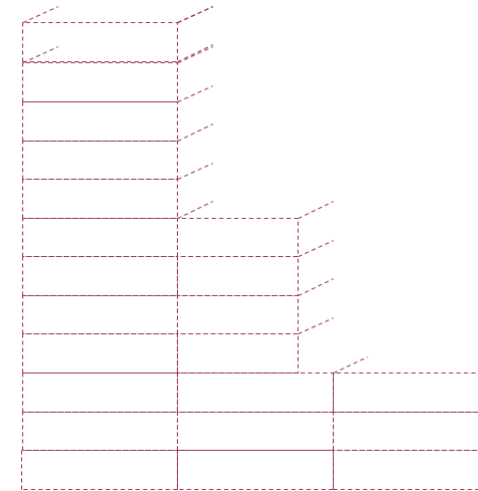

Alle Nutzungen

R / EI / REI
REI 30 / REI 30 – RF1
REI 60 / REI 60 – RF1
REI 90 / REI 90 – RF1

Brandschutz



Brandschutz



Brandschutz



Können

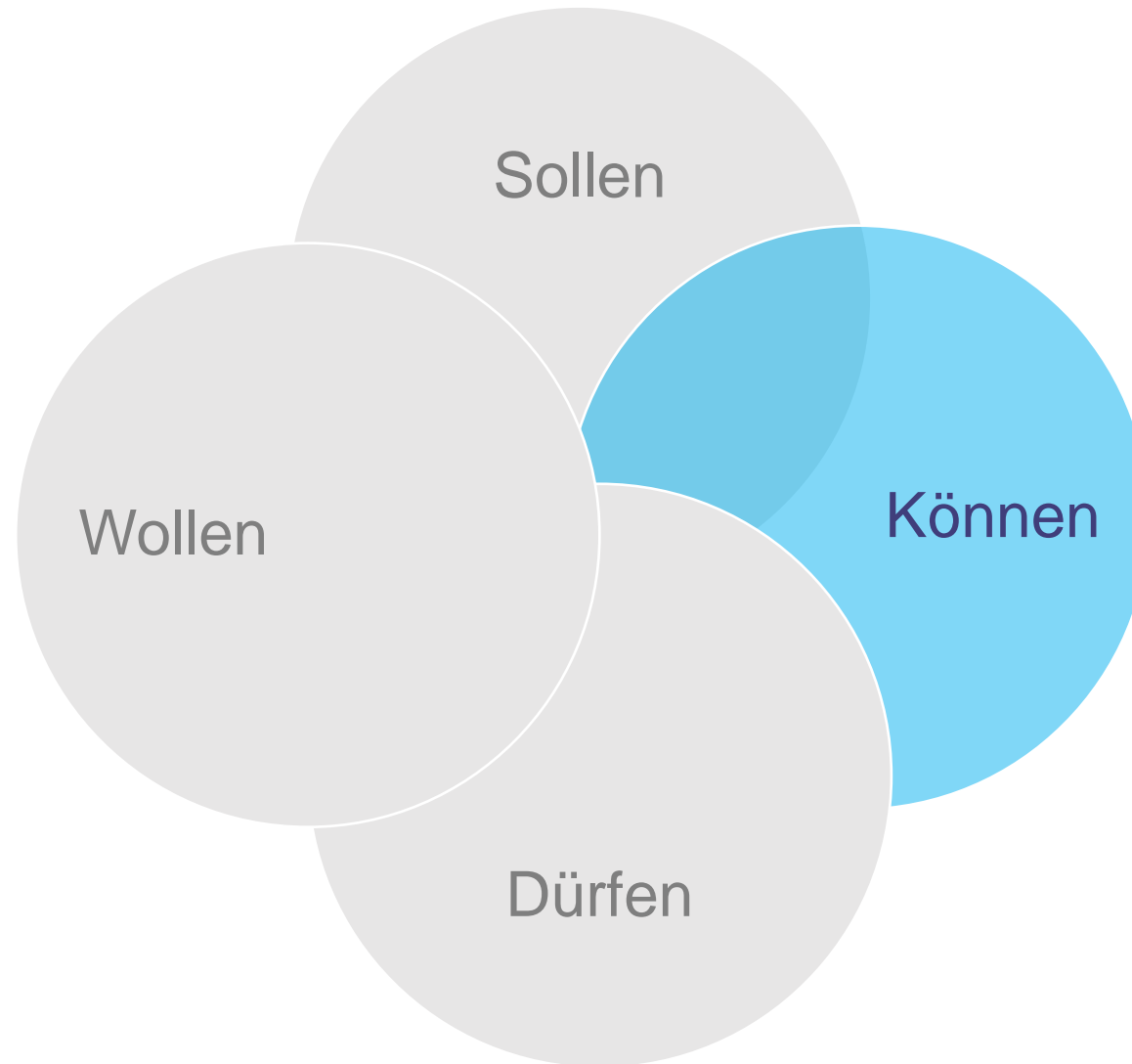

A construction worker wearing a white hard hat, safety glasses, and a high-visibility yellow vest stands in a room under construction. The room features a large, light-colored wooden beam leaning against a wall. A window in the background offers a view of a lake and rolling hills. The floor is concrete, and the walls are partially framed with dark wood studs. The word "Können" is overlaid in white text on the worker.

Können

Können

Eishalle Davos, 1987

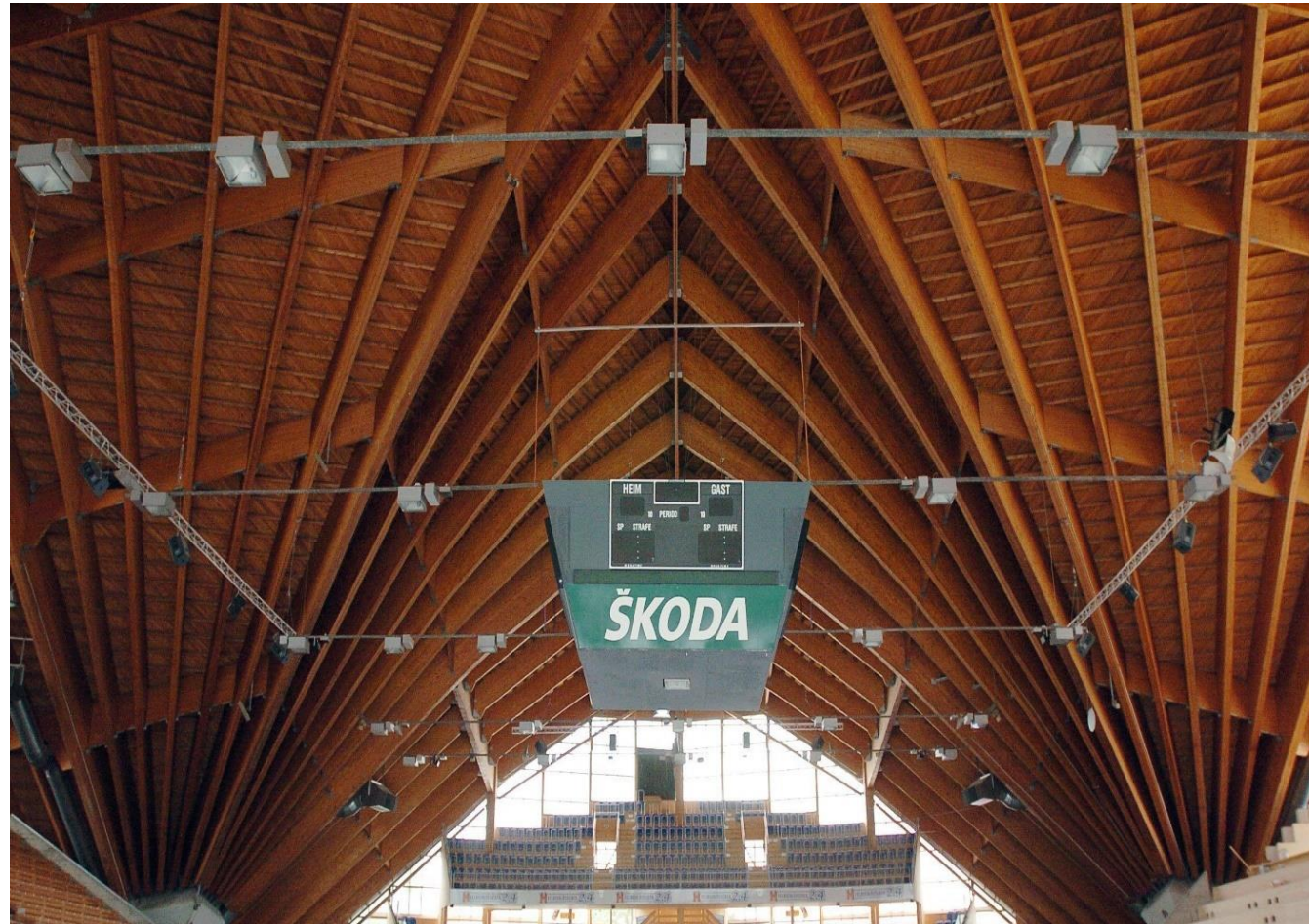

Können

Elefantenhaus Zürich, 2014



Können

Swatch Gebäude Biel, 2018



Können

Wildtierüberführung Rynetel Suhr, 2021



Wollen

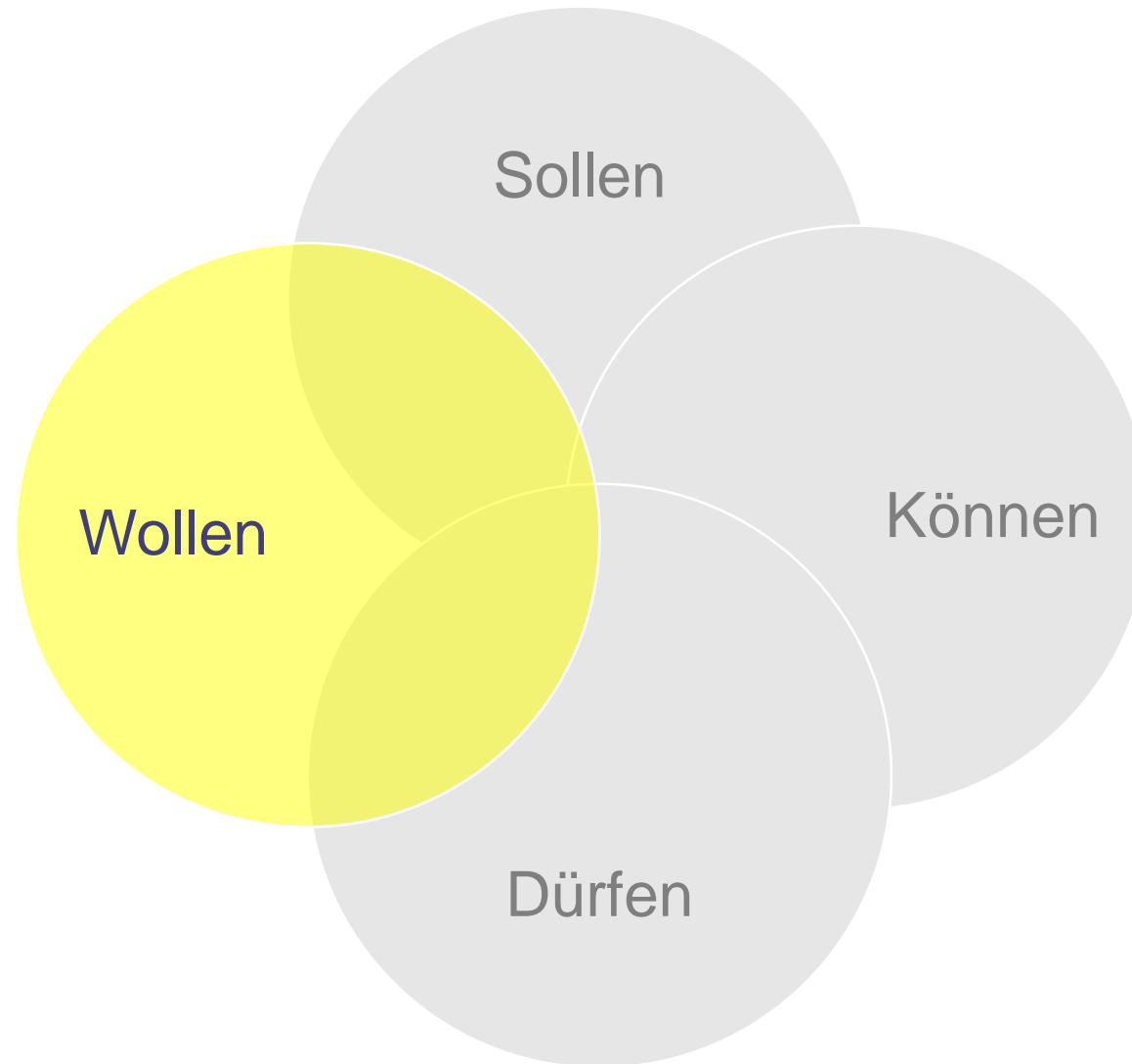

A low-angle, upward-looking photograph of a light-colored wooden beam. The beam is the central focus, showing its natural wood grain and texture. It extends from the bottom left towards the top right, creating a strong sense of height and aspiration. The background is a clear, vibrant blue sky with a few scattered, soft white clouds. The overall mood is bright, clean, and positive.

Wollen

hoch – höher – am höchsten



hoch – höher – am höchsten

UBC Brock Commos

Vancouver

2017

55 Meter



hoch – höher – am höchsten

HoHo

Wien

2019

84 Meter



hoch – höher – am höchsten

Mjøstårnet

Norwegen

2019

85.4 Meter



hoch – höher – am höchsten

Suurstoffi

Risch Rotkreuz

2018

36 Meter



hoch – höher – am höchsten

Zwahtt

Regensdorf

2024

75 Meter



hoch – höher – am höchsten

Lausanne, 2026, 85 m



Winterthur, 2026, 100 m



Zürich, 2026, 108 m

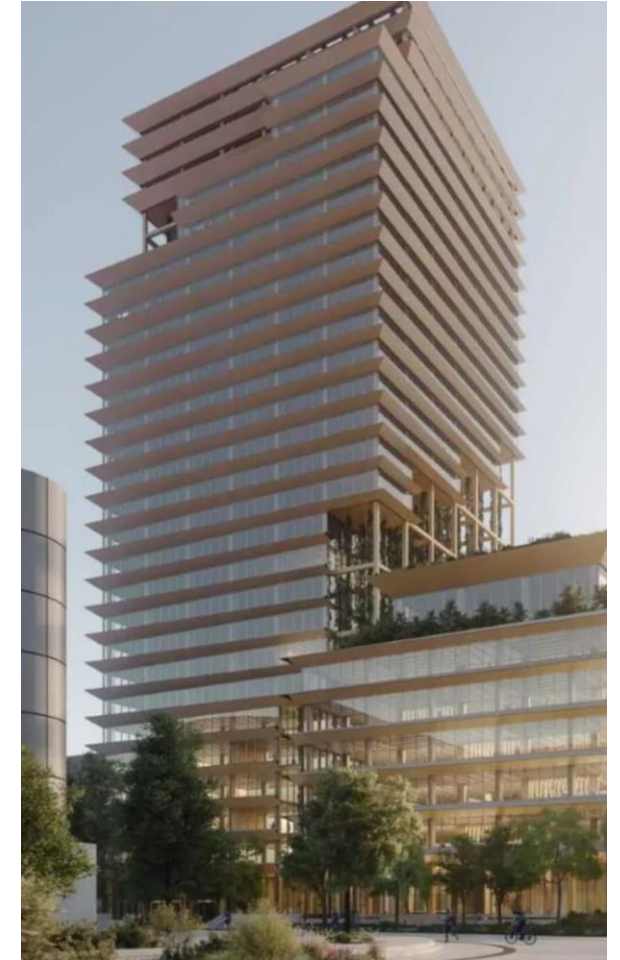

hoch – höher – am höchsten

W350 Tower
Tokyo

2041

350 Meter



Welcome to the Wood-Nation

Neues Dock A
Flughafen Zürich
2037



Vielen Dank

SEMIRAMIS

Die hängenden Gärten von Zug

Quellen: einige Folien und Grafiken wurden von Prof. Dr. Andrea Frangi zur Verfügung gestellt. – Vielen Dank

Timbatec
Timber and Technology

